

5. Installation and Maintenance Instructions for Packing Seals

See Figure 5.1 to 5.4, they are how to disassembly and assembly the packing.
In Figures, 9 is packing box, 10 is press cover, 151 is stud, 152 is washer, 153 is nut and 200 is packing.

5.1 Loosen nuts **153** and remove washers **152** and press cover **10**.

5.2 Pull out the broken or worn packing with special tool (Dismantle hook for packing).

- Note**
- a) The surface of the shafts and packing box should be protected from be damaged.
 - b) The packing should be pulled out one by one.

5.3 Wash and clean packing box to ensure there is no residue left in the box.

5.4 Check the internal surface of the packing box and the surface of the shaft to find whether there is some scratch. Any damage should be repaired before assembling packing.

5.5 Grease all packings, push every packing to the bottom of packing box smoothly and press every piece packing tightly with soft bushing.

5.6 Assembly press cover **10**, washer **152**, and tighten them by nuts **153**.

- Note**
- a) The later packing can be pushed in until the prior one was pressed to the bottom.
 - b) The opening between two adjacent packing must be staggered 120°.
 - c) Tighten nut **153** should be carefully, it must not too tight or too loose (The suitable force is there is obvious leakage or temperature rise during tightening nuts).

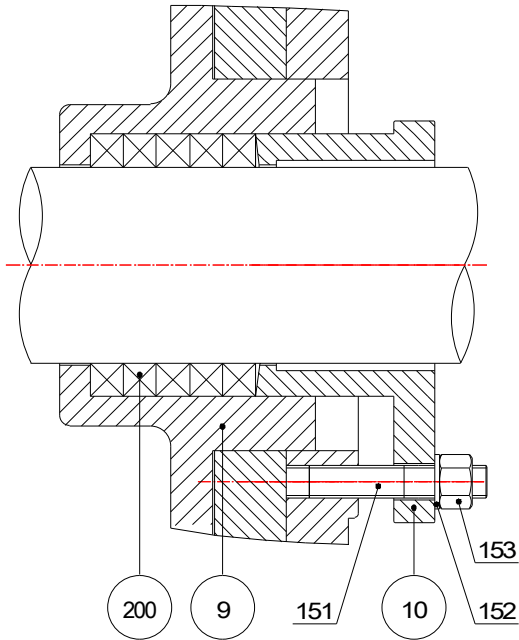

Figure 5.1

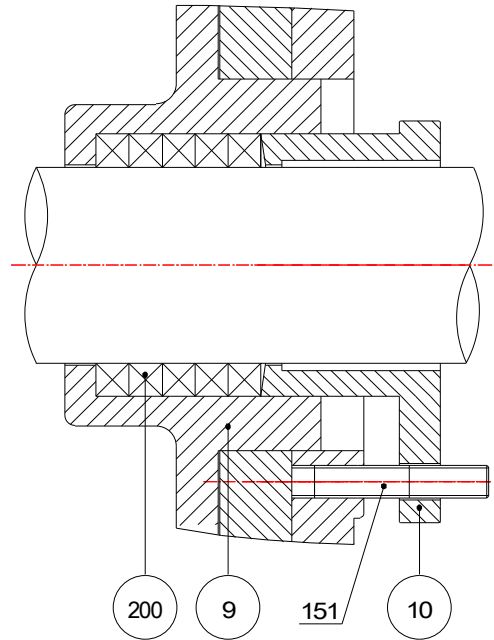

Figure 5.2

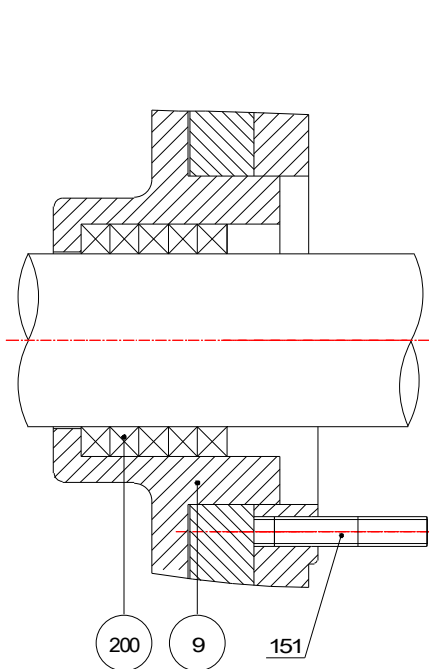

Figure 5.3

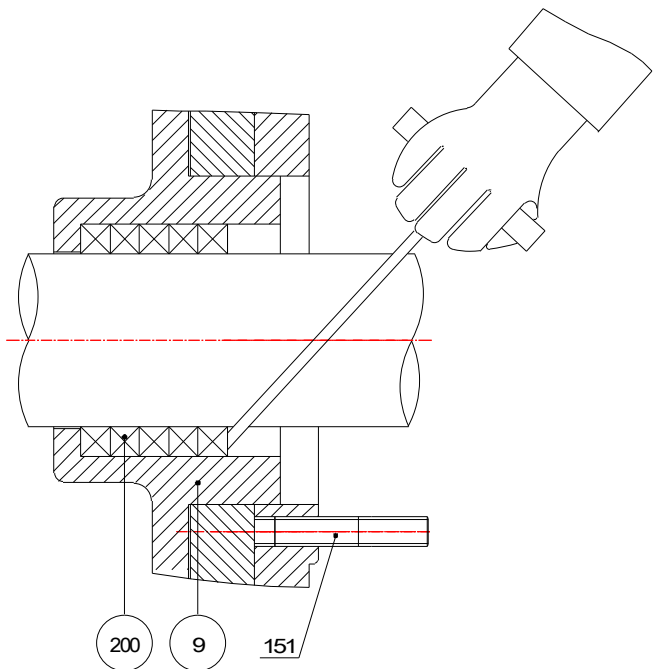

Figure 5.4